

FREEHOLD



House - End Terrace

DERBY CLOSE, LANGDON HILLS, BASILDON, SS16 6EA

Asking Price

£220,000

FEATURES

- No onward chain
- One bedroom house
- Situated in the popular Great Berry area
- Own front door
- Freehold property
- Allocated parking for 2 vehicles
- Air conditioning/additional heating
- Council Tax Band: B



STEPS
Estate Agents

1 Bedroom House - End Terrace located in Basildon

Welcome to this charming one-bedroom chain free property located in the desirable Derby Close, nestled within the Great Berry area of Langdon Hills, Basildon. This freehold home offers a perfect blend of comfort and convenience, making it an ideal choice for first-time buyers or those seeking a cosy retreat.

Upon entering, you will find a well-appointed lobby area that provides a warm and inviting atmosphere.

The property boasts a spacious bedroom, providing a peaceful sanctuary for rest and rejuvenation. The bathroom is thoughtfully designed, ensuring both functionality and style.

Additionally, this property comes with allocated parking for two vehicles, a valuable asset in this sought-after area. The Great Berry neighbourhood is known for its friendly community and proximity to local amenities, making it a convenient place to live.

In summary, this one-bedroom home in Derby Close presents an excellent opportunity for those looking to settle in a vibrant and welcoming community. With its modern features and practical layout, it is sure to appeal to a variety of buyers. Do not miss the chance to make this delightful property your own.

Call us on
020 8593 5933

dagenham@steps.me.uk
www.steps.me.uk

Council Tax Band
B

GROUND FLOOR

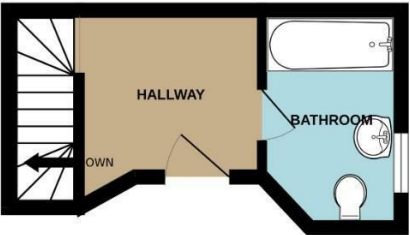

FIRST FLOOR

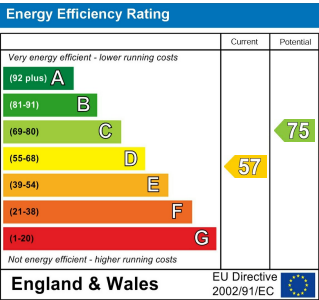

Agents Note: Whilst every care has been taken to prepare these particulars, they are for guidance purposes only. All measurements are approximate and are for general guidance purposes only and whilst every care has been taken to ensure their accuracy, they should not be relied upon and potential buyers are advised to recheck the measurements.

Whilst every attempt has been made to ensure the accuracy of the floorplan contained here, measurements of doors, windows, rooms and any other items are approximate and no responsibility is taken for any error, omission or mis-statement. This plan is for illustrative purposes only and should be used as such by any prospective purchaser. The services, systems and appliances shown have not been tested and no guarantee as to their operability or efficiency can be given.
Made with Metropix ©2025

